

VOERE M2



Preface.....	2
Key features.....	2
Characteristics	3
Measurement	4
Weight	4
Material / Surface finish / Colour.....	4
Stock adjustment.....	4
Trigger	5
Safety.....	5
Magazine	5
Sight.....	5
Offered Accessories.....	6
VOERE M2 composition.....	7
Maintenance	7

VOERE M2



Preface

Using the LBW action we developed a modern series of bolt action long-range rifle for law-enforcement applications. It is characterised by a high degree of modularity and outstanding accuracy, vastly superior towards conventional rifle designs.

The LBW M2 is the X3's smaller sister designed to accept smaller cartridges like the 223 Rem. The differences are visible in the shorter length of the action and bolt as well as the magazines which are the same as on the LBW series. This weapon is also characterised by a high degree of stability and ruggedness essential for long-range accuracy, as well as by its fully modular design.

Due to its new revolutionary design and construction the total costs of ownership are comparatively low by minimising maintenance.

Key features

- Outstanding precision
- Barrels and calibre interchangeable
- Extreme flexibility
- Low cost of ownership
- Low costs of maintenance
- Safe to use
- Long durability

VOERE M2



Characteristics

The VOERE M2 is a full modular multi-calibre precision rifle enabling the operator deliver surgical precise fire onto selected targets at long ranges. The VOERE M2 is alternatively available with or without switch barrel system in following calibres:

- 223 Rem
- 6,5x47 Lapua
- 6,5 Creedmoor
- 6,5x55
- 308 Win.
- 300 Win. Mag.

The VOERE M2 is made of high quality materials, utilising modern coatings and precision CNC manufacturing resulting in outstanding toughness, reliability and accuracy.

The integrated cocking-safety offers a significant advantage in terms of safety.

The NATO-STANAG 4694 (MIL-STD 1913 Picatinny) rails placed on the action and forend offer all options to place optics and NVD's. The forend design also allows the barrel to cool down quickly.

The fully adjustable stock is available as either right or left side folding or fixed stock. The attached monopod features a quick adjustable button and a fine tuning wheel for elevation adjustment. Additionally the stock accepts a sandbag-rest, if required.

High quality all-steel magazines are available in various capacities.

The two-stage trigger is fully adjustable between 700g-1300g / 24.5oz-46oz. and by using a different spring up to 3000g / 100oz.

In the switch-barrel version, the barrel can be exchanged within one minute by the operator in the field, while the fixed barrel version allows the barrel to be detached by armorers only. The screwed on muzzle brake accepts silencers with 18x1 LH threads and BUIS front sights, if requested.

The VOERE M2 features two independent operating safeties: A cocking-safety for transport and a thumb safety. An alternative 3-position firing pin safety is available on option.

VOERE M2



Measurement

Barrel length 51 cm / 20", folded:	830 mm / 32.7"
Barrel length 51 cm / 20", not folded:	1060 mm / 41.7"
Barrel length 66 cm / 24", folded:	980 mm / 38.6"
Barrel length 66 cm / 24", not folded:	1210 mm / 47.6"
Barrel length 69 cm / 26", folded:	1010 mm / 39.7"
Barrel length 69 cm / 26", not folded:	1240 mm / 48.8"

Weight

Including bipod, without scope:	7.3 kg / 16 lbs
---------------------------------	-----------------

Material / Surface finish / Colour

Barrel:	Stainless steel, Cerakote
Action:	7075 Aluminium, Cerakote, anodised
Bolt:	Steel, 7075 Aluminium composite construction
Chassis/Stock:	7075 Aluminium, Cerakote, anodised
Magazine:	Sheet metal, Cerakote, anodised
Mount:	7075 Aluminium, Cerakote, anodised

Stock adjustment

Stock adjustment range:	48 mm / 1.88"
Butt plate adjustment range:	70 mm / 2.75"
Cheek rest height adjustment range:	17.5 mm / 0.68"
Cheek rest position adjustment range:	20 mm / 0.78"
Grip:	AR-15 Interface

VOERE M2



Trigger

Adjustable:	Trigger Stop, weight from 700g - 1300g / 24.5oz - 100oz
Trigger guard:	Folding trigger guard

Safety

3-position safety	<ol style="list-style-type: none">1. Safe position2. Firing position3. Safe position and the bolt can be opened.
-------------------	--

Magazine

223 Rem.	5-rounds capacity
6,5x47 Lapua	5-rounds capacity
6,5 Creedmoor	5-rounds capacity
6,5x55	5-rounds capacity
308 Win.	5-rounds capacity
300 Win. Mag.	5-rounds capacity

Sight

Night Vision Device	Mounts on forend
Scope:	Picatinny-rail (0, 20, 30, or 40 MOA)

VOERE M2



Offered Accessories

Adapter for fire control system

BUIS

Back-up iron sights

Case catcher

Cleaning set

Flash hider

Folding trigger guard

Harris bipod

I-Phone clamp

Magazine

available in different sizes

Mirage band

Mono block mount

Ø 30 mm / 34 mm / 36 mm, (0, 20, 35, 50 MOA)

NVD mount

Rifle sling

Sandbag rest

Single stage trigger

Torx key set

Transport case

VOERE M2



VOERE M2 composition

The VOERE M2 consists of 11 components only what makes the rifle both easy to maintain as well as quick to adapt to the operators need. The tools required for disassembly are included.

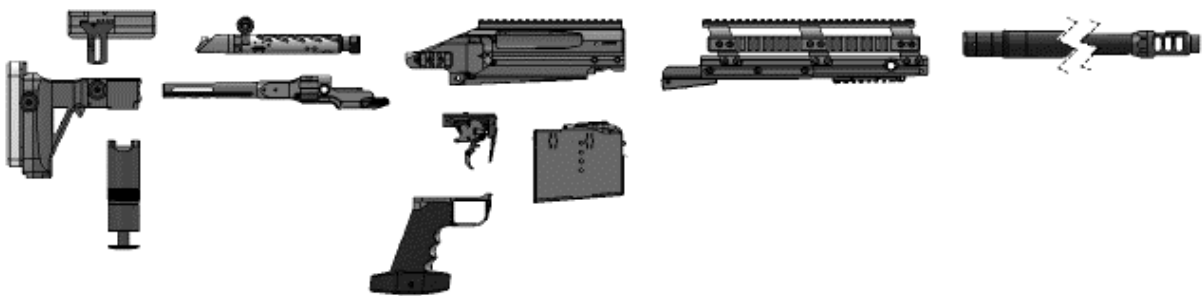

Maintenance

Due to the simple and robust design the rifle can be maintained without the need of any special tools, machinery or highly trained technical personnel. All parts are interchangeable between the rifles.

The results are low maintenance time and costs.

Additionally we offer armorer courses for LE personnel. Each rifle set comes with a safety regulations brochure and instruction manual.